

SPRING / SUMMER 2021

# UPGRADE YOUR EVERYDAY



Husqvarna®

READY WHEN YOU ARE



## 40 MONTHS INTEREST FREE\*

Available on all Automower®, Lawn Tractor, Zero Turn and Rider models.

\*Approved applicants only  
Fees and T&Cs apply – see page 20. Offer ends 31/01/2022

### TRIMMERS FROM \$235<sup>+</sup>



\*Refers L22C. See Page 8 for details.

### LAWN MOWERS FROM \$535<sup>A</sup>



\*Refers LC118. See Page 14 for details.

### FREE! TRAILER<sup>S</sup>

VALUED AT \$399<sup>S</sup>



<sup>S</sup>Bonus with models R216, R316TX, R316TSXAWD. See Page 15 for details.

### LAWN TRACTORS FROM \$3,735<sup>®</sup>



® Refers TS138. See Page 18 for details.

### ZTR® ZERO TURN MOWERS FROM \$6,049<sup>X</sup>



<sup>X</sup>Refers Z146. See Page 16 for details.

HUSQVARNA.COM

# AUTOMOWER®

## THE SMART WAY TO MOW

WORLD LEADER IN ROBOTIC MOWING SINCE 1995



SEE HUSQVARNA AUTOMOWER® IN ACTION  
WWW.HUSQVARNA.COM

## HOW IT WORKS!

Automower® keeps your garden in perfect shape, running effortlessly by itself, day or night, rain or shine, or be in full control via the Automower®connect app.

### MOWING CYCLE

- The concept is to keep short grass short.
- Husqvarna Automower® finds the charging station automatically.
- Charges for approximately 60 minutes.
- Resumes mowing, day in and day out, rain or shine.

### RECHARGING

When it's time to recharge, the mower finds the charger by using one of three methods:

- Picking up a signal from the charging station antenna.
- Following the guide wire back to the charging station.
- Following the boundary wire until its within reach of the home signal.

### BOUNDARY WIRE

### RANDOM MOVEMENT PATTERN

- No need for specific programming.
- Covers all parts even if lawn is complex and/or contains trees, flowerbeds, passages etc.
- Allows the grass to be cut from different directions creating a smooth carpet like surface.

### GUIDE WIRE

 <b>ADVANCED NAVIGATION</b>	 <b>RECHARGES ITSELF</b>	 <b>CUTS UNEVEN LAWN</b>	 <b>NO TRACK MARKS</b>	 <b>LESS NOISE</b>	 <b>MANAGES PASSAGES</b>	 <b>WORKS IN THE RAIN</b>	 <b>MANAGES SLOPES (UP TO)</b>
--	--	--	--	--	--	---	--



# LOVE IT OR YOUR MONEY BACK!\*

\*Terms and Conditions apply. See husqvarna.com for full details. (No refund on installation costs).

# RECEIVE A **FREE** CLEANING & MAINTENANCE KIT AND QUALIFY FOR **5 YEARS EXTENDED WARRANTY!**<sup>^</sup>



<sup>^</sup>Offer valid 01/09/21 - 31/01/22 with all Husqvarna Automower® models, while stocks last at participating Elite Automower® Dealers only. Free Cleaning and Maintenance Kit valued at \$59. T&Cs apply to Husqvarna Care®, refer [www.husqvarna.com](http://www.husqvarna.com) for details.

**5 YEAR EXTENDED WARRANTY INCLUDED\***

## **H** AM305

600m<sup>2</sup> working area - 55m<sup>2</sup>/h cutting capacity - Max incline 40% (22°)  
Ideal for smaller gardens. Connect@HOME puts you in control from your smartphone. Featuring smart technology, weather resistance and theft protection.



**CLICK & COLLECT** SHOP THE AM305 SELF-INSTALL UNIT ONLINE AND COLLECT IN-STORE \$1,858 (INCLUDES SMALL INSTALLATION KIT)

**\$1,699\*** RRP

## **H** AM310

1000m<sup>2</sup> Working Area - 56m<sup>2</sup>/h Cutting Capacity - Max Incline 40% (22°)  
Features Connect@HOME Bluetooth® solution, smart technology, automatic passage handling, theft protection and weather resistant.

**5 YEAR EXTENDED WARRANTY INCLUDED\***



**CLICK & COLLECT** SHOP THE AM310 SELF-INSTALL UNIT ONLINE AND COLLECT IN-STORE \$2,228 (INCLUDES MEDIUM INSTALLATION KIT)

**\$1,999\*** RRP

## **H** AM315X

1600m<sup>2</sup> Working Area - 73m<sup>2</sup>/h Cutting Capacity - Max Incline 40% (22°)  
Equipped with the premium X-Line design, Automower® Connect with GPS theft tracking, GPS assisted navigation - you can also use voice control with Google Home or Amazon Alexa - LED headlights, front rubber bumper, weather resistant.

**5 YEAR EXTENDED WARRANTY INCLUDED\***



**CLICK & COLLECT** SHOP THE AM315X SELF-INSTALL UNIT ONLINE AND COLLECT IN-STORE \$3,628 (INCLUDES MEDIUM INSTALLATION KIT)

**\$3,399\*** RRP

## **L** AM430X

3200m<sup>2</sup> Working Area - 133m<sup>2</sup>/h Cutting Capacity - Max Incline 45% (24°)  
Smart enough to navigate large and complex lawns, multiple narrow passages, obstacles, tough terrain and slopes with superior control thanks to the to GPS theft tracking, the GPS-assisted navigation and Automower® Connect - you can also use voice control with Google Home or Amazon Alexa.

**5 YEAR EXTENDED WARRANTY INCLUDED\***



**\$4,409\*** RRP

## **L** AM450X

5000m<sup>2</sup> Working Area - 208m<sup>2</sup>/h Cutting Capacity - Max Incline 45% (24°)  
Fully equipped to keep large lawns green, healthy and perfectly mowed. Automower® Connect, theft tracking and GPS-assisted navigation ensures easy maintenance of large areas, tough terrain and slopes up to 24°.

**5 YEAR EXTENDED WARRANTY INCLUDED\***



**\$5,249\*** RRP

\*Prices refer to units only. Installation kits sold separately. Installation costs apply.



**40 MONTHS INTEREST FREE\***



\*Approved applicants only. Fees and T&Cs apply – see page 20. Offer ends 31/01/2022.

5 YEAR  
EXTENDED  
WARRANTY  
INCLUDED<sup>^</sup>

# HUSQVARNA AM435 AWD

## THE WORLD'S FIRST AWD AUTOMOWER<sup>®</sup>



### L AM435X AWD

3500m<sup>2</sup> Working Area - 146m<sup>2</sup>/h - Cutting Capacity - Max Incline 70% (35°)  
A pioneer on the robotic lawn mower market. An all-wheel-drive model that makes light work of lawns up to 3,500 m<sup>2</sup> and navigates obstacles, rough terrain and slopes up to an impressive 70% (35°). The mower features superior rough terrain performance and ultrasonic collision detection, X-line design with LED headlights and is equipped with Automower<sup>®</sup> Connect including GPS theft tracking.

**\$6,299<sup>RRP</sup>**

### P AM550

5000m<sup>2</sup> Working Area - 208m<sup>2</sup>/h Cutting Capacity - Max Incline 45% (24°)  
Designed for professional fleet use. Offering remote control and theft tracking through Husqvarna Fleet Services<sup>™</sup> delivering full mower control and configuration via a smartphone.

5 YEAR  
EXTENDED  
WARRANTY  
INCLUDED<sup>^</sup>



**\$5,775<sup>RRP</sup>**

### P AM535 AWD

3500m<sup>2</sup> Working Area - 146m<sup>2</sup>/h Cutting Capacity - Max Incline 70% (35°)  
An advanced and highly effective professional robotic mower with All-Wheel-Drive to navigate obstacles, tough terrain and mowing on slopes of up to 70% (35°). Includes Husqvarna Fleet Services<sup>™</sup> for easy management.

5 YEAR  
EXTENDED  
WARRANTY  
INCLUDED<sup>^</sup>



**\$6,615<sup>RRP</sup>**

\*Prices refer to units only. Installation kits sold separately. Installation costs apply.

### + ACCESSORISE YOUR ROBOTIC MOWER



#### INSTALLATION KITS

Includes required Loop Wire, Staples, Splicers and Connectors to suit different sized areas. Available in 3 sizes, ask your Husqvarna Dealer which kit is suitable for your lawn.

Small **\$159<sup>RRP</sup>**

Medium **\$229<sup>RRP</sup>**

Large **\$355<sup>RRP</sup>**



#### WHEEL BRUSH KIT

Keeps the driving wheels clean to maintain good traction. **FROM \$52**



#### ENDURANCE BLADES

Husqvarna Automower<sup>®</sup> Endurance blade's new design allows for a harder and sharper edge without compromising on safety standards and provides cutting edges on all 4 sides.

6 pcs **\$40<sup>RRP</sup>** 45 pcs **\$209<sup>RRP</sup>**

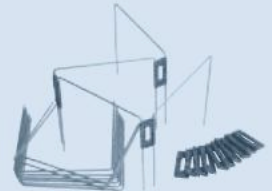

#### TEMPORARY FENCE

Ideal solution when you need to temporarily fence off a certain lawn area from being mowed by your robot. **\$60<sup>RRP</sup>**



#### ROUGH TERRAIN KIT

Provides excellent traction on rough and sloping lawns.

**FROM \$139**



#### HOUSING

Protects the charging station and the robotic lawnmower from exposure to sun and rain. **\$439<sup>RRP</sup>**



**SHOP ONLINE. COLLECT IN-STORE.**

**HUSQVARNA.COM**



**CHOOSE THE RIGHT MACHINE FOR YOUR NEEDS**

**H HOMEOWNER**

Medium Duty - Seasonal or occasional use.

**L LANDOWNER**

Heavy Duty - Frequent or demanding use.

**P PROFESSIONAL**

Extreme Duty - All day, every day use.

# HUSQVARNA BATTERY SOLUTION



## H 115iL KIT

77 dB(A) - 33cm Cutting Width - 4.25kg with battery  
Quiet, lightweight, comfortable and easy to use battery trimmer for lawn edges or small areas of higher grass. Intuitive keypad for safe, convenient starting and stopping.



**\$483** KIT PRICE  
RRP

(Kit incl. Skin, BLi10 Battery, QC80 Charger)

**SKIN ONLY**  
**\$249**

## L 325iLK

82 dB(A) - 42cm Cutting Width - 4.6kg with battery  
A perfectly balanced, high performance battery combi trimmer that delivers superior output. When used with the professional range of optional attachments, it is an extremely flexible multi-purpose tool.



**\$599** SKIN ONLY  
RRP

Recommended BLi200 Battery and QC500 Charger

## H 115iHD45 KIT

45cm Bar - 25mm Teeth Opening - 4.0kg with battery  
Easy to use and easy to handle. Ideal for cutting small to medium hedges. A long-lasting Li-ion battery makes it a great choice for homeowners.



**\$509** KIT PRICE  
RRP

(Kit incl. Skin, BLi10 Battery, QC80 Charger)

**SKIN ONLY**  
**\$275**

## H 120iB KIT

46m/s - 3.2kg with battery  
Lightweight and easy to use battery blower for small to medium gardens. Convenient, easy starts, fast acceleration, low weight and three modes.



**\$599** KIT PRICE  
RRP

(Kit incl. Skin, BLi20 Battery, QC80 Charger)

**SKIN ONLY**  
**\$335**

## H 120i KIT

12" Bar - 3/8" LP Chain - 4.15kg with battery  
A lightweight, easy to use battery chainsaw ideal for home pruning tasks and cutting small branches. Features an intuitive keypad for safe, convenient starting.



**\$603** KIT PRICE  
RRP

(Kit incl. Skin, BLi20 Battery, QC80 Charger)

**SKIN ONLY**  
**\$339**

## L 340i

14" Bar - 3/8" LP Chain - 4.1kg with battery  
A light and versatile battery-powered chainsaw delivering great cutting capacity for all-round use such as felling, pruning, cutting firewood or carpentry.



**\$599** SKIN ONLY  
RRP

Recommended BLi20 Battery and QC80 Charger

## H LC141i KIT

50L Collect - BioClip® / Rear Eject - Cutting Width 41cm  
Ideal for smaller lawns.



**\$835** KIT PRICE  
RRP

(Kit incl. Skin, BLi20 Battery, QC80 Charger)

**SKIN ONLY \$575**

## H LC347iVX

55L Collector - BioClip® / Rear Eject - Cutting Width 47cm  
Self-propelled, easy to use mower with dual battery slots for use with one or two batteries.



SELF  
PROPELLED

**\$839** SKIN ONLY  
RRP

Recommended BLi20 Battery, QC80 Charger

## H S138i NEW!

Cutting Width 38cm - 45L Collector  
A light-weight battery-powered, cordless scarifier with a 2-in-1 function and easy blade shift.



**\$1,028** KIT PRICE  
RRP

(Kit incl. Skin, 2 x BLi20 Batteries, QC80 Charger)

**SKIN ONLY \$555**



CARE

## 5 YEAR DOMESTIC WARRANTY<sup>#</sup>

Simply service your Husqvarna battery products annually at an authorised Husqvarna Servicing Dealer for 5 years<sup>#</sup> peace of mind.

<sup>#</sup>Terms and Conditions apply, visit husqvarna.com or ask in-store for details.

# CHARGE UP



SCAN THE QR CODE TO EXPLORE THE HUSQVARNA BATTERY SERIES



## P 520iLX

761 dB(A) - 40cm Cutting Width - 4.3kg with battery  
A lightweight and high performance trimmer with for professional users. Features a 2-way rotation trimmer head. Perfect for gardeners, landscapers and contractors.



**\$575** SKIN ONLY  
RRP

Recommended BLi200 Battery and QC500 Charger

## P 520iRX

761 dB(A) - 40cm Cutting Width - 5.1kg with battery  
Lightweight, professional brushcutter with great ergonomics, 2-way rotation trimmer head and 3-tooth grass blade.



**\$695** SKIN ONLY  
RRP

Recommended BLi200 Battery and QC500 Charger

## P 535iRXT

80.2 dB(A) - 45cm Cutting Width - 6.8kg with battery  
Robust, high-performance professional brushcutter that delivers power output equivalent to a 35cc petrol unit, without all the noise.



**\$909** SKIN ONLY  
RRP

Recommended BLi300 Battery and QC500 Charger

## P 520iHD60

60cm Bar - 30mm Teeth Opening - 5.1kg with battery  
Quiet, lightweight, high performance hedge trimmer with a pivoting rear handle for easy cutting in all positions.



**\$725** SKIN ONLY  
RRP

Recommended BLi200 Battery and QC500 Charger

## P 520iHE3

55cm Bar - 32mm Teeth Opening - 5.45kg with battery  
Highly efficient pole hedge trimmer with 3.5m reach. Remote adjustment of cutting head angle and economy savE™ mode.



**\$785** SKIN ONLY  
RRP

Recommended BLi200 Battery and QC500 Charger

## P 520iHT4

55cm Bar - 32mm Teeth Opening - 6.8kg with battery  
High-capacity telescopic pole hedge trimmer with up to 4.5m reach, designed for professional use.



**\$869** SKIN ONLY  
RRP

Recommended BLi200 Battery and QC500 Charger

## + BATTERIES, CHARGERS AND ACCESSORIES



### HUSQVARNA BATTERIES

Li-ion 36V batteries equipped with a cooling system for lasting power and performance.

BLi10 **\$179** RRP BLi200X **\$299** RRP  
BLi20 **\$209** RRP BLi300 **\$419** RRP  
BLi200 **\$259** RRP

### HUSQVARNA BACKPACK BATTERIES

BLi550X **\$1,049** RRP BLi950X **\$2,205** RRP



### HUSQVARNA QUICK CHARGERS

Super-fast charging with active cooling of the batteries.

QC250 **\$179** RRP  
QC500 **\$265** RRP

### HUSQVARNA CHARGERS

Compact battery chargers with 12V-socket ideal for home use or on-the-go charging in the car.

240V QC80: **\$105** RRP  
12V In-car QC80F: **\$125** RRP



### HUSQVARNA BATTERY STORAGE

Insulating, splash water-proof and shock-absorbing bag for Husqvarna BLi 10/20/200 batteries.

BLi Battery Bag: **\$49** RRP  
Small Box: 400x300x160mm **\$85** RRP  
Large Box: 600x300x210mm **\$109** RRP

## + WHY CHOOSE BATTERY?



36V LITHIUM-ION POWER



ZERO EMISSIONS



SIMPLE STARTS



LOW NOISE



LIGHT WEIGHT



WEATHERPROOF (IPX4)  
(500-SERIES UNITS)

**P** **525iB**

48m/s - 3.7kg with battery

Well-balanced, comfortable and efficient professional battery blower. Low noise level, variable speed and cruise control.



**\$555** SKIN ONLY  
RRP

Recommended BLi200 Battery and QC500 Charger

**P** **530iBX**

49.6m/s - 2.9kg excl. battery

Powered by Husqvarna's powerful BLi backpack battery, the handheld 530iBX blower is low in weight but big on all-weather performance.



**\$805** SKIN ONLY  
RRP

Recommended BLi Backpack Battery and QC500 Charger

**L** **340iBT**

52m/s - 10.1kg with 2 x BLi300 batteries

Powerful backpack battery blower with low levels of noise and vibration, featuring dual battery slots.



**\$545** SKIN ONLY  
RRP

Recommended 2 x BLi300 Batteries and QC500 Charger

**P** **550iBTX**

54m/s - 6.3kg excl. battery module

A powerful, well-balanced and ergonomic backpack battery blower with impressive blow force (up to 21N).



**\$869** SKIN ONLY  
RRP

Recommended BLi550X / BLi950X Battery Module & QC500 Charger

**P** **535iXP®**

14" Bar - .325" Mini Pixel Chain - 3.9kg with battery

Powerful, lightweight, high performance battery saw with excellent ergonomics and fast chain speed.



**\$679** SKIN ONLY  
RRP

Recommended BLi200 Battery and QC500 Charger

**P** **540iXP®**

14" Bar - .325" Mini Pixel Chain - 4.2kg with battery

Class-leading, powerful battery saw with superior performance, design and functionality including smart connectivity.



**\$869** SKIN ONLY  
RRP

Recommended BLi300/BLi200X Battery & QC500 Charger

**P** **T535iXP®**

12" Bar - .325" Mini Pixel Chain - 3.7kg with battery

Ideal arborists chainsaw with superior performance, excellent ergonomics, zero emissions, low vibrations and high chain speed.



**\$679** SKIN ONLY  
RRP

Recommended BLi200 Battery and QC500 Charger

**P** **T540iXP®**

12" Bar - .325" Mini Pixel Chain - 3.8kg with battery

Performance equivalent to a 40cc petrol saw, but with all the benefits of battery power - clean, lightweight, well-balanced, with smart connectivity.



**\$869** SKIN ONLY  
RRP

Recommended BLi200X Battery and QC500 Charger

**P** **530iPX**

10" Bar - 3m Reach - 4.4kg with battery

An agile and lightweight battery powered pole clearing saw with a 90 degree adjustable cutting head to quickly switch between horizontal and vertical bar position.



**\$735** SKIN ONLY  
RRP

Recommended BLi200 Battery and QC500 Charger

**P** **530iP4**

10" Bar - 4m Reach - 4.7kg with battery

Battery operated, fixed length pole saw for efficient tree care. Low weight and well balanced design, with low vibrations and a high chain speed for the perfect cut.



**\$735** SKIN ONLY  
RRP

Recommended BLi200 Battery and QC500 Charger

**P** **530iPT5**

10" Bar - 5m Reach - 6.3kg with battery

A robust pole saw with telescopic shaft for maximum reach. Lightweight and high performing with extremely low vibrations and no direct emissions.



**\$785** SKIN ONLY  
RRP

Recommended BLi200 Battery and QC500 Charger

**CHOOSE THE RIGHT MACHINE FOR YOUR NEEDS**

**H HOMEOWNER**

Medium Duty - Seasonal or occasional use.

**L LANDOWNER**

Heavy Duty - Frequent or demanding use.

**P PROFESSIONAL**

Extreme Duty - All day, every day use.



# TRIMMING WITH EASE

## H 122C

217cc - 0.6kW - 4.4kg  
Trimming lawn edges around the home is simple with this easy starting grass trimmer featuring low weight and low noise.

**HOT PRICE!**



**\$235** \$265 RRP

## H 129C

276cc - 0.85kW - 4.5kg  
Make tough jobs easy. A robust curved shaft trimmer that combines high power with a focus on ease of use.



**\$319** \$369 RRP

## L 322L

22.5cc - 0.8kW - 4.2kg  
Trim like a professional. This grass trimmer delivers superb performance, ease of use and high durability.



**\$450** \$525 RRP

## P 522L

22.5cc - 0.8kW - 4.2kg  
Professional, durable grass trimmer with intuitive controls like Smart Start®, delivering faster starting efficiency and ease of use.



**\$534** \$609 RRP

## H 129R

276cc - 0.85kW - 5.4kg  
Versatile, powerful brushcutter complete with trimmer head, grass blade and double-harness.



**\$445** \$495 RRP

## P 525RS

25.4cc - 1.0kW - 5.0kg  
Professional brushcutter built for tough trimming applications. Easy to use, maintain and service.



**\$689** \$789 RRP

## P 545RXT-AT

45.7cc - 2.2kW - 8.6kg  
A brushcutter for professional users. Its combination of power, performance and comfort means high productivity and low user strain.



**\$1,689** \$1,839 RRP

### ALSO AVAILABLE

555FX Clearing Saw - 53.3cc - 2.8kW - 8.9kg

**\$2,579** \$2,729 RRP

For battery products, please see pages 5-7

### + HUSQVARNA GENUINE ACCESSORIES TRIMMER LINE



#### WHISPER TWIST

• Ideal for battery products  
Designed for residential and professional use. A unique profile to maximise performance and durability with reduced noise and vibrations. **FROM \$5.95**



#### OPTI ROUND

• All-round general purpose line  
Ideal for a wide range of applications. Excellent wear resistance and cutting performance. **FROM \$5.50**



#### CORE CUT - PENTA

• Fits all standard trimmer heads.  
Dual Pro Polymer material with a flexible inner core and durable anti-weld surface made to last. **FROM \$7.50**



## H 129LK COMBI TRIMMER

276cc - 0.85kw - 4.67kg

Multi-purpose tool for homeowners with a powerful, yet easy to start engine and intuitive controls. Supplied standard with the trimmer attachment, this machine can be easily equipped with a number of optional attachments: edger, pole saw, cultivator, hedge trimmer, blower, bristle brush, sweeper or dethatcher.



**\$399** ~~\$449~~ RRP

OPTIONAL ATTACHMENTS FROM \$265\* \*Refers to Edger. See in-store for details.

## P 525RJD COMBI TRIMMER

24.5cc - 1.0kw - 4.9kg

A highly efficient, robustly built and versatile brush cutter. Comes with a combi guard, trimmer head and grass blade, which allow you to handle a range of demanding work tasks. *Optional attachments available.*



**\$689** ~~\$789~~ RRP

## P 535LK COMBI TRIMMER

34.6cc - 1.5kW - 5.8kg

High-powered, heavy duty, with reliable X-Torq® engine. Anti-vibration system and soft-grip handles ensure comfortable use even during long shifts. *Optional attachments available.*



**\$849** ~~\$949~~ RRP

AVAILABLE FROM 1 OCTOBER 2021

# FREE! CONTRACTORS KIT<sup>†</sup>

**KIT INCLUDES:** TOOLBAG, CAP, GARDEN EARMUFFS, CLEAR PROTECTIVE GLASSES AND CORE CUT TRIMMER LINE (2.7MM X 12M DONUT).



VALUED AT  
OVER  
**\$160<sup>†</sup>**

<sup>†</sup>Offer available 01/10/2021 - 31/01/2022 on the following models: 525LST, 535RXT while stocks last at participating Husqvarna Dealers.

## P 525LST

25.4cc - 1.0kW - 4.7kg

A powerful garden trimmer with a high torque gear box. The machine has a robust construction with durable components and is easy to maintain.

**FREE!**  
CONTRACTORS  
KIT<sup>†</sup>



**\$789** RRP

## P 535RXT

34.6cc - 1.6kW - 6.7kg

A petrol powered professional brushcutter, built for tough commercial use. Top class performance with excellent durability.

**FREE!**  
CONTRACTORS  
KIT<sup>†</sup>



**\$1,239** RRP



CLICK &  
COLLECT

SHOP ONLINE. COLLECT IN-STORE.  
[HUSQVARNA.COM](https://www.husqvarna.com)



# BLOWERS FROM \$295\*



\*Refers model 125B

## H 125B

28.0cc - 76m/s - 4.26kg  
An efficient hand held leaf blower that combines high blowing power with user friendliness.

**HOT  
PRICE!**



**\$295** \$345 RRP

## H 125BVX

28.0cc - 76m/s - 4.35kg  
Low weight, high power and easy to use. Ideal for a quick clean up around the house. Includes vac kit.



**\$349** \$399 RRP

## P 525BX

25.4cc - 86m/s - 4.3kg  
Powerful, well balanced hand-held blower. The special fan and housing design provides high blowing capacity.



**\$510** \$585 RRP

## P 580BTS

75.6cc - 93m/s - 11.8kg  
Powerful commercial backpack blower designed for demanding tasks. Large air flow and high speed ensure trouble free use.



**\$1,049** \$1,149 RRP

## H 122HD45

21.7cc - 45cm Bar/28mm Teeth Opening - 4.7kg  
The ideal hedge trimmer for home use. Light weight, low noise and easy to use with Smart Start® technology.



**\$384** \$459 RRP

## H 122HD60

21.7cc - 59cm Bar/28mm Teeth Opening - 4.9kg  
Low noise, lightweight hedge trimmer with adjustable rear handle and Smart Start® technology.



**\$495** \$545 RRP

## L 322HD60

21.7cc - 60cm Bar/30mm Teeth Opening - 5.2kg  
Double-sided hedge trimmer designed for rugged use. Multi-position handle and low overall weight for easy manoeuvring.



**\$635** \$735 RRP

## P 522HD60RS

21.7cc - 60cm Bar/30.5mm Teeth Opening - 5.1kg  
Professional double-sided hedge trimmer featuring high torque, adjustable rear handle and high capacity cutting output.



**\$795** \$895 RRP

## P 522HS75S

21.7cc - 75cm Bar/30mm Teeth Opening - 5.1kg  
Single-sided hedge trimmer with a 75cm cutter bar for trimming jobs. Equipped with a leaf catcher for easy clean-up.



**\$899** \$999 RRP

## P 525HE4

25.4cc - 60cm Knife/30mm Teeth Opening - 6.3kg  
Pole hedge trimmer with outstanding reach of up to 4m, 37mm blade pitch and 135° angle adjustment to efficiently trim all high, wide and low hedges.



**\$1,425** \$1,525 RRP



## 5 YEAR DOMESTIC WARRANTY<sup>#</sup>

Purchase genuine Husqvarna oil with your new Husqvarna petrol products to extend the standard 2 year domestic warranty period to 5 years. <sup>#</sup>Terms and Conditions apply, see HUSQVARNA.COM for details.

CARE



# MORE CUT FOR YOUR CASH

## H 120E MARK II

38.2cc - 1.4kW - 16" Bar - 3/8" LP Chain - 5.1kg

Easy to use chainsaw for homeowners with ample power to make light work of pruning tasks and cutting firewood.

**\$419** RRP



## H 130

38.0cc - 1.5kW - 16" Bar - 3/8" LP Chain - 4.7kg

A lightweight chainsaw, featuring a low kick back cutting chain and full chain brake safety system for maximum protection.

**\$475** RRP



## H 135 MARK II

38.0cc - 1.6kW - 16" Bar - 3/8" LP Chain - 4.7kg

Starts quickly, handles easily and delivers excellent cutting performance making it the perfect garden chainsaw.

**\$579** RRP



## L 435 E-SERIES II

40.9cc - 1.6kW - 16" Bar - .325 Pixel Chain - 4.4kg

A lightweight, powerful and efficient chainsaw, ideal for those looking for a saw that is exceptionally easy to start and manoeuvre.

**\$735** RRP



## L 440 E-SERIES II

40.9cc - 1.8kW - 16" Bar - .325 Pixel Chain - 4.4kg

An efficient saw combining user-friendly functionality, raw power, lower emissions and superior chain technology.

**\$859** RRP



## L 445 E-SERIES II

45.7cc - 2.1kW - 18" Bar - .325 Pixel Chain - 5.1kg

Excellent all-round saw that combines performance with fuel efficiency. Ideal for cutting firewood and general maintenance on the land.

**\$965** RRP



## L 450 E-SERIES II

50.2cc - 2.4kW - 20" Bar - .325 Pixel Chain - 5.1kg

Reliable workmate with more power, less fuel, lower emissions and reduced vibrations. Features Smart Start® and fuel pump for easy starts.

**\$1,135** RRP



## L 455R

55.5cc - 2.6kW - 20" Bar - 3/8" Chain - 6.0kg

An ideal saw for landowners and those who require a high powered, heavy-duty and responsive workmate for all cutting conditions.

**\$1,289** RRP



## L 460

60.3cc - 2.7kW - 20" Bar - 3/8" Chain - 5.8kg

For demanding jobs that require high power when cutting with longer bars. Delivers high torque over a wide rpm.

**\$1,399** RRP



## L 565 AT

70.6cc - 3.7kW - 20" Bar - 3/8" Chain - 6.5kg

Excellent cooling capacity and state of the art air filtration means great performance and easy operation, even for the toughest jobs.

**\$1,605** RRP



### CHAINSAWS - ALSO AVAILABLE

T525	270cc - 1.1kW - 12" - 3/8LP Chain - 2.7kg	\$895 RRP	572 XP*	70.6cc - 4.3kW - 20" - 3/8" Chain - 6.6kg	\$2,089 RRP
T540XP II	377cc - 1.8kW - 12" - 3/8LP Chain - 3.9kg	\$1,525 RRP	390 XP*	88.0cc - 4.8kW - 24" - 3/8" Chain - 7.3kg	\$2,309 RRP
550 XP*	501cc - 3.0kW - 16" - .325 Pixel Chain - 5.3kg	\$1,575 RRP	395 XP*	94.0cc - 4.9kW - 24" - 3/8" Chain - 7.9kg	\$2,415 RRP
562 XP*	59.8cc - 3.5kW - 20" - 3/8" Chain - 6.1kg	\$1,825 RRP	3120 XP*	118.8cc - 6.2kW - 28" - .404 Chain - 10.4kg	\$3,119 RRP

# KEEP YOUR LAWN AND GARDEN HEALTHY

Husqvarna sprayers are designed to meet the demands of both commercial and residential landscaping applications.



## 1.5L SPRAYER

Perfect for smaller jobs or spot treatment applications. Genuine Viton® seals, weighted dip tube, integrated pressure relief valve and includes multiple nozzles.



**\$28.95** RRP

## 8L SPRAYER

Durable and efficient with genuine Viton® seals, reinforced PVC hose, extra long 25" (635mm) stainless steel wand with poly liner, tear-drop design and multiple nozzles included.



**\$79** RRP

## NEW! 8L BATTERY

This battery powered sprayer features a Lithium-Ion pump and charger, meaning there is no pumping involved and it can spray up to 90 litres per charge. Perfect for smaller jobs and spot treatment applications.



**\$179** RRP

## 15L SPRAYER

Extra comfort backpack harness with lumbar support. Efficient, no-leak and easy repair. Genuine Viton® seals, and multiple nozzles, including 25PSI pressure regulator.



**\$209** RRP

# WET AND DRY VACUUM CLEANERS

Built to offer the robust performance and durability you need to tackle just about any kind of dirt, dust, spill and debris. Powerful performance, intuitive controls, smart storage and easy transport make the machines well prepared for tough everyday cleaning.



WDC 220

WDC 325L

## H WDC 220

1000W - 3600 l/m - 72 dB(A) - 7.4kg

Compact and user-friendly cleaner, with washable PET filter, a smart lifting handle on the container, and a robust design. 20L Container capacity (11L liquid), 2.5m hose length.

**\$315** RRP

## H WDC 325L

1000W - 3700 l/m - 72 dB(A) - 8.5kg

Strong and reliable turbine with high capacity, intuitive operation, smart storage make the machine prepared for heavy daily cleaning. 25L Container capacity (16L liquid), power tool capable, 3.5m hose length, certified to Dust Class L.

**\$475** RRP

## + HUSQVARNA GENUINE VACUUM CLEANER ACCESSORIES



### FILTER BAG FLEECE - 5 PCS

One fleece filter bag is included with the new machine. Filter bags in sets of five are available as accessories. **\$29.95** RRP



### FLOOR NOZZLE - SWITCHABLE, 270MM

The handy floor nozzle is perfect for vacuuming floors and carpets thanks to its duo mode. **\$59.95** RRP



### VEHICLE CLEANING KIT

A set of three attachments for more versatility: a round brush, a dusting brush, and a rubber nozzle. **\$74.95** RRP

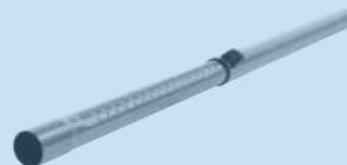

### TELESCOPIC TUBE - STAINLESS

The stainless telescopic tube gives you extra durability and flexibility when handling tougher tasks. **\$74.95** RRP



# WATER POWER WITH PRECISION

## H PW125

1500w - Max Pressure 125 Bar / 1813 psi - Water flow 320-460 Ltr/hr

Our most compact and lightweight model, ideal for easy and convenient cleaning of patios and garden equipment. Supplied with: 7m hose, foam sprayer, variable flat jet and rotary nozzles.

**\$209** \$229 RRP



## H PW235R

1800w - Max Pressure 135 Bar / 1958 psi  
Water flow 350-520 Ltr/hr

All-round, high-pressure machine. Ideal for most cleaning tasks around the home. Supplied with: 8m hose, foam sprayer, variable flat jet and rotary nozzles.

**\$349** \$389 RRP



## H PW360

2300w - Max Pressure 160 Bar / 2321 psi  
Water flow 420-500 Ltr/hr

Designed for excellent results on demanding jobs. Features a Low Force grip for easy activation. Supplied with: 10m hose, foam sprayer, variable flat jet and rotary nozzles.

**\$579** \$629 RRP



## L PW490

2400w - Max Pressure 160 Bar / 2321 psi  
Water flow 470-520 Ltr/hr

Top of the range, high performance with out-standing durability. Features a brass pump and integrated detergent tank. Supplied with: 15m hose, premium flat jet and rotary nozzles.

**\$929** \$1,029 RRP



### + HUSQVARNA GENUINE PRESSURE WASHER ACCESSORIES



#### STONE & WOOD CLEANER 2.5L & VEHICLE CLEANER 2.5L

Highly effective detergents ideal for cleaning pavements, bricks and wood or cars and vehicles.

**\$22.50** RRP EA.



#### FOAM SPRAYER

An efficient and fast covering foam sprayer with a dosage button for the perfect dosage depending on the task.

**\$55** RRP



#### ROTATING BRUSH KIT

Includes: Three different brushes that can be mounted for soft, hard and difficult to reach surfaces.

**\$109** RRP



#### VEHICLE CLEANING KIT

Contains wide fan jet nozzle for quick and gentle cleaning of sensitive surfaces, an angled nozzle, and a wash brush with a squeegee.

**\$109** RRP



#### SURFACE CLEANERS

Efficient rotating cleaners with power regulation, making it easy to select the optimal pressure. Suitable for cleaning both vertical and horizontal larger surface areas.

SC300 **\$99** RRP

SC400 **\$149** RRP

### + HUSQVARNA GENUINE TOYS! SUITABLE FOR CHILDREN 3 YEARS AND UP, BATTERIES INCLUDED



#### TOY CHAINSAW KIT

Looks like a real Husqvarna 440 Chainsaw! Featuring realistic chainsaw sounds and a moving plastic chain. **\$49.95** RRP



#### TOY HEDGE TRIMMER

Looks like a real Husqvarna 122HD45 Hedge Trimmer! Makes realistic sounds and moves back and forth just like the real thing. **\$47.95** RRP

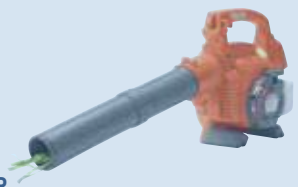

#### TOY BLOWER

Looks like a real Husqvarna 125B Blower! It makes realistic blower sounds and air really blows from the nozzle when the trigger is pulled! **\$47.95** RRP



#### TOY TRIMMER

Just like a real grass trimmer. Pull the trigger to hear the engine start up and the trimmer line light up and spin around! **\$47.95** RRP



#### TOY LAWN MOWER

Husqvarna's toy mower is perfect for budding professionals. Featuring realistic engine sounds and lights, **\$62.95** RRP



#### TOY AUTOMOWER®

Amazing new Automower® toy for your kids! Looking just like a real Husqvarna AM450X this toy also features flashing head lights. **\$99.95** RRP

# A CUT ABOVE THE REST

**HOT  
PRICE!**



## **H** LC118

Husqvarna Series™ - 139cc - BioClip® / Collect - Cutting Width 46cm - 44L Collector

Robust and easy to use with four cutting blades that delivers a superior cut and finish. Features include dual ball bearing wheels, comfort grip folding handles with quick action cam locks, safety zone starting, large plastic catcher and eight cutting heights. Comes complete with mulch insert.

**\$535** \$575 RRP

## **H** LC219P

Husqvarna Series™ - 166cc - BioClip® / Collect  
Cutting Width 48cm - 44L Collector

Versatile and powerful. Easy to start and delivers a superior cut and finish.



**\$695** \$735 RRP

## **H** LC419A

Husqvarna Series™ - 166cc - BioClip® / Collect  
Cutting Width 48cm - 44L Collector

Large alloy cutting deck for long life and more efficient cutting plus a powerful engine and four cutting blades.



**\$799** \$839 RRP

## **L** LC419SP

Husqvarna Series™ - 166cc - BioClip® / Collect  
Cutting Width 48cm - 44L Collector

High quality, self-propelled lawn mower with a durable alloy cutting deck featuring four blades.



**\$895** \$945 RRP

## **P** LC19AP

Briggs & Stratton - 161cc - BioClip® / Collect  
Cutting Width 48cm - 44L Collector

A commercial quality lawn mower with a large alloy cutting deck plus a powerful engine.



**\$945** \$995 RRP

## **P** LB548Se

Honda OHV - 166cc - BioClip® - Cutting Width 48cm

A solid and rugged self-propelled mower for daily use. Cast aluminium cutting deck for strength and durability.



**\$1,419** \$1,469 RRP

## **P** LB553Se

Honda OHV - 166cc - BioClip® - Cutting Width 53cm

A reliable and dedicated mower for mid to large gardens. Extraordinary cutting results, even in wet weather.



**\$1,599** \$1,649 RRP

### **+** HUSQVARNA GENUINE ACCESSORIES

#### **GARDEN EARMUFFS**

Light, comfortable with an extra wide headband for secure fit.

**\$36.95** RRP



#### **FM RADIO EARMUFFS**

Providing superior sound quality and comfort. Includes AUX Audio input for connectivity. **\$179.95** RRP



#### **GLOVES**

Offering the latest in comfort, style and durability. Designed for the most demanding tasks and a perfect fit.

**FROM \$18.95** Classic Light



#### **EYE PROTECTION**

X-series feature scratch resistant lenses with extendable frames and angle adjustable lenses. Available in clear, tint and yellow. **FROM \$19.95**



## H R216

Briggs & Stratton Intek 4155 - 8.5kW - 94cm Cutting Width - 30cm Uncut Circle

The Husqvarna R216 combines ease of use and excellent handling, with power and performance to deliver exceptional cutting results and a truly enjoyable ride.



FREE!  
TRAILER<sup>§</sup>

**\$7,559** RRP

Incl. 94cm cutting deck

# FREE! TRAILER VALUED AT \$399<sup>§</sup>



<sup>§</sup>Offer valid 01/09/2021 - 31/01/2022 with the following Rider models:

R216, R316TX, R316TSXAWD while stocks last, at participating Husqvarna Dealers Only.

## L R316TX

Kawasaki FS Series V-Twin - 9.6kW - 103cm Cutting Width - 30cm Uncut Circle

Easy to use, versatile rider provides smooth operation and efficient mowing results. Equipped with intuitive display, dual headlights and Bluetooth.



FREE!  
TRAILER<sup>§</sup>

**\$9,149** RRP

Incl. 103cm cutting deck

## L R316TSXAWD

Kawasaki FS Series V-Twin - 9.8kW - 112cm Cutting Width - 30cm Uncut Circle

Powerful and versatile with twin-cylinder engine and All-Wheel-Drive. Suitable for landowners who demand superior efficiency, manoeuvrability and perfect results all year round.



FREE!  
TRAILER<sup>§</sup>

**\$12,379** RRP

Incl. 112cm cutting deck

## L RC318T

Husqvarna Endurance Series™ V-Twin - 12.6kW - 103-112cm Cutting Width - 50cm Uncut Circle

Innovative design with turn key start makes operation easy, while the articulated steering gives excellent manoeuvrability.



**\$14,485** RRP

Incl. with 103cm cutting deck (or \$14,905 RRP with 112cm deck)

## L RC320TS AWD

Husqvarna Endurance Series™ V-Twin - 12.6kW - 103-112cm Cutting Width - 50cm Uncut Circle

Tough, versatile rider with innovative anti-clog collection system, power steering and AWD. Excellent ergonomics and huge collection capacity.



**\$17,320** RRP

Incl. with 103cm cutting deck (or \$17,740 RRP with 112cm deck)

**hummm<sup>90</sup>**  
Built to shop.

# 40 MONTHS INTEREST FREE\*



\*Approved applicants only. Fees and T&Cs apply – see page 20. Offer ends 31/01/2022.

# TAKE CHARGE

## H Z146

Kawasaki FR Series V-Twin - 18.0hp  
46" Cutting Width - 2.4 acres/hr

Performance and style hit the grass running with the Z146 Zero Turn Mower. Cutting edge design, proven performance and new innovative features combine to make lawn maintenance an event instead of a chore.

**\$6,049** \$6,299 RRP



**HOT  
PRICE!**

## L MZ48

Kawasaki FR Series V-Twin - 23.0hp  
48" Cutting Width - 3.3 acres/hr  
With a compact size, ClearCut™ fabricated deck and high performance, the MZ48 is a dependable partner for landowners and professionals.

**\$10,999** RRP



**CONTRACTORS  
CHOICE**

## L MZ54

Kawasaki FR Series V-Twin - 24.0hp  
54" Cutting Width - 3.5 acres/hr  
With a rugged fabricated steel deck that is mulch and collection capable, the MZ54 is practical for all of your property maintenance needs.

**\$11,549** RRP



## P Z460

Kawasaki FS Series V-Twin - 23.0hp  
60" Cutting Width - 4.85 acres/hr  
Powerful mower with fast and efficient performances. Equipped with an integrated transmission, LED digital fuel gauge, rubber discharge chute, folding ROPS, integrated parking brake and an effective commercial 10 gauge cutting deck

**\$14,175** RRP



## P Z554

Kawasaki FX Series V-Twin - 24.5hp  
54" Cutting Width - 4.4 acres/hr  
Providing extreme comfort, high ground speeds and superior traction adds up to exceptional mowing efficiency. Industrial strength throughout the entire design assures a long and durable service

**\$16,275** RRP



## P Z560X

Kawasaki FX Series V-Twin - 31.0hp  
60" Cutting Width - 5.8 acres/hr  
The Husqvarna Z500 series zero turn mower represents the latest design focused on productivity, durability and cut quality.

**\$19,425** RRP



## P Z572X

Kawasaki FX Series V-Twin - 31.0hp  
72" Cutting Width - 7.0 acres/hr  
Providing extreme comfort, high ground speeds and superior traction. Industrial strength throughout the entire design assures a long and durable service life.

**\$20,475** RRP





# FREE!

## 45L ICEBOX AND BUCKET HAT\*

\*Offer available 01/09/2021 - 31/01/2022 on the following Husqvarna models:  
TRACTORS: TS242TXD, TS248TXD, TS354, TC242TX,  
ZERO-TURN MOWERS: Z242E, Z242F, Z248F, Z254F.  
While stocks last at participating Husqvarna Dealers only.



VALUED AT OVER  
**\$270<sup>x</sup>**

### **H** Z242E

Kawasaki FR Series V-Twin - 18.0hp - 42" Cutting Width - 2.2 Acres/hr  
Easy to start, simple operation and proven performance. The ClearCut™ fabricated cutting Deck provides unsurpassed cutting results.



**FREE!**  
ICEBOX AND  
BUCKET  
HAT\*

**\$7,139** RRP

### **L** Z242F

Kawasaki FR Series V-Twin - 21.5hp - 42" Cutting Width - 2.2 acres/hr  
Cut like a professional with true zero turn performance and heavy-duty ClearCut™ fabricated deck for landowners with open lawn areas.



**FREE!**  
ICEBOX AND  
BUCKET  
HAT\*

**\$7,769** RRP

### **L** Z248F

Kawasaki FR Series V-Twin - 23.0hp - 48" Cutting Width - 2.5 acres/hr  
High performance mower with a ClearCut™ fabricated cutting deck specifically designed for durability, performance and an even cut.



**FREE!**  
ICEBOX AND  
BUCKET  
HAT\*

**\$8,399** RRP

### **L** Z254F

Kawasaki FR Series V-Twin - 24.0hp - 54" Cutting Width - 2.8 acres/hr  
Built to withstand tough conditions with a rock-solid frame, powerful engine and high performance ClearCut™ fabricated deck, you can cut like a pro at home.



**FREE!**  
ICEBOX AND  
BUCKET  
HAT\*

**\$8,819** RRP

**hummer<sup>90</sup>**  
Built to shop.

## 40 MONTHS INTEREST FREE\*



\*Approved applicants only. Fees and T&Cs apply – see page 20. Offer ends 31/01/2022.

# POWER THROUGH MORE THIS SEASON

HOT PRICE!

## H TS138

Husqvarna Series™ Engine - 14.7hp - 38" Cutting Width

User-friendly lawn tractor with foot-pedal operation, side ejection cutting deck and powerful engine to tackle smaller blocks.

**\$3,735** \$3,885 RRP



## H TS142

Husqvarna Series™ Engine - 18.6hp - 42" Cutting Width

Ideal for small to mid-size gardens. Side ejection, smart design plus a powerful engine and pedal-operated hydrostatic transmission.

**\$4,399** RRP



## H TS142T

Husqvarna Series™ V-Twin Engine - 764cc - 42" Cutting Width

Compact side discharge tractor with smart, user-friendly design, developed for use in small to mid-size gardens. Equipped with pedal-operated, hydrostatic transmission, 15" deluxe seat and ergonomic steering wheel.

**\$5,145** RRP



## H TS142TXD

Kawasaki FR Series V-Twin - 21.5hp - 42" Cutting Width

Ideal for homeowners and landowners with larger gardens who need a durable and comfortable tractor with high manoeuvrability.

**\$5,669** RRP



## H TC138T

Husqvarna Series™ V-Twin Engine - 764cc - 38" Cutting Width

An efficient garden tractor that offers excellent collection of grass clippings giving tidy cutting results.

**\$6,599** RRP



### + HUSQVARNA GENUINE ACCESSORIES



#### HUSQVARNA OILS

2-Stroke Low Smoke+oil is a mix of mineral and synthetic oils.

**FROM \$17.95** RRP



4-Stroke Premium multi-grade engine oil

**FROM \$13.95** RRP

#### 15L FUEL CAN

Featuring three ergonomically positioned handles and specially designed spout. Easy to lift, carry and refuel, without any splash or waste.

**\$64.95** RRP



#### SEAT COVER

Fits tractor seats with backrests up to 15" tall. **\$85** RRP



#### TRACTOR COVER

Heavy duty fabric. Handy storage bag. Fits tractors with decks up to 54". **\$159** RRP

# FREE!

## 45L ICEBOX AND BUCKET HAT\*

VALUED AT OVER  
**\$270<sup>x</sup>**



\*Offer available 01/09/2021 - 31/01/2022 on the following Husqvarna models:  
TRACTORS: TS242TXD, TS248TXD, TS354, TC242TX,  
ZERO TURN MOWERS: Z242E, Z242F, Z248F, Z254F.  
While stocks last at participating Husqvarna Dealers only.

**FREE!**  
ICEBOX AND  
BUCKET  
HAT\*

### L TS242TXD

Kawasaki FR Series V-Twin - 21.5hp - 42" Cutting Width  
Ideal for regular use in medium-sized to large gardens. It is characterized by the 107cm wide ClearCut™ cutting deck, the intelligent, user-friendly design and the simple starting process by turning the key.



**\$6,719** RRP

### L TS248TXD

Kawasaki FR Series V-Twin - 23.0hp - 48" Cutting Width  
A powerful and comfortable side discharge tractor with sturdy ClearCut™ deck for medium to large-sized gardens. Hydrostatic with automatic transmission for easy, trouble-free operation that gives superior traction in slippery conditions and slopes.



**\$7,245** RRP

**FREE!**  
ICEBOX AND  
BUCKET  
HAT\*

### L TC242TX

Kawasaki FR Series V-Twin - 21.5hp - 42" Cutting Width  
A powerful, durable and comfortable tractor with pedal-operated transmission, cruise control and automatic diff lock for superior traction.



**\$7,665** RRP

**FREE!**  
ICEBOX AND  
BUCKET  
HAT\*

### L TS354

Kawasaki FR Series V-Twin - 24.0hp - 54" Cutting Width  
Premium tractor with ClearCut™ fabricated deck, heavy-duty transmission with electric diff lock and superior comfort features.



**\$8,559** RRP

**FREE!**  
ICEBOX AND  
BUCKET  
HAT\*

**hum**90  
Built to shop.

40 MONTHS INTEREST FREE\*



\*Approved applicants only. Fees and T&Cs apply – see page 20. Offer ends 31/01/2022.



## 5 YEAR DOMESTIC WARRANTY<sup>#</sup>

Purchase genuine Husqvarna oil with your new Husqvarna petrol products to extend the standard 2 year domestic warranty period to 5 years. <sup>#</sup>Terms and Conditions apply, see HUSQVARNA.COM for details.



CARE

# HUSQVARNA AUTOMOWER®

## OVER 25 YEARS OF PERFECT LAWNS

SHOP ONLINE.  
COLLECT IN-STORE.  
[HUSQVARNA.COM](https://www.husqvarna.com)



SCAN TO DISCOVER OUR AUTOMOWER® INNOVATION STORY



## LARGEST RANGE UNDER ONE BRAND



With over 330 years of innovation and passion, Husqvarna offers the largest range of outdoor power equipment under the one trusted and reliable brand. Supported by a network of over 390 dealers nationwide, we've got your needs covered. To view the complete range and learn more visit [husqvarna.com](https://www.husqvarna.com) today.

**YOUR LOCAL AUTHORISED HUSQVARNA DEALER:**

#### 40 MONTHS INTEREST FREE TERMS AND CONDITIONS

\*40 months Interest Free available 1 September 2021 until 31 January 2022. Approved applicants at humm90 participating Husqvarna dealers only. Fees, terms, conditions & minimum finance amount \$1300 applies, including a \$99 Annual Fee charged on first debit to your humm90 Account and annually thereafter, which attracts interest (charged at the humm90 Purchase Rate, currently 23.99% p.a.) from the date charged unless fully paid within Interest Free Period and the Interest Free Criteria are met. Minimum monthly repayment required. Interest, (charged at the Expired Promotional Rate, currently 25.99% p.a.) payable on outstanding balance after the Interest Free Period expires. Credit provided by humm Cards Pty Ltd ABN 31 099 651 877 Australian Credit Licence number 247415.

**IMPORTANT INFORMATION** Husqvarna conducts continuous product development and reserves the right to change designs, specifications and equipment levels without prior notice. All technical data was current at the time of printing. All images are for illustrative purposes only. All prices include GST and are Recommended Retail Prices only. Prices subject to change without notice. All offers valid 01/09/2021-31/01/2022, or while stocks last, at participating Authorised Husqvarna Dealers only. Terms and Conditions apply to all offers and Husqvarna Care™. For full details visit [WWW.HUSQVARNA.COM](https://www.husqvarna.com)